

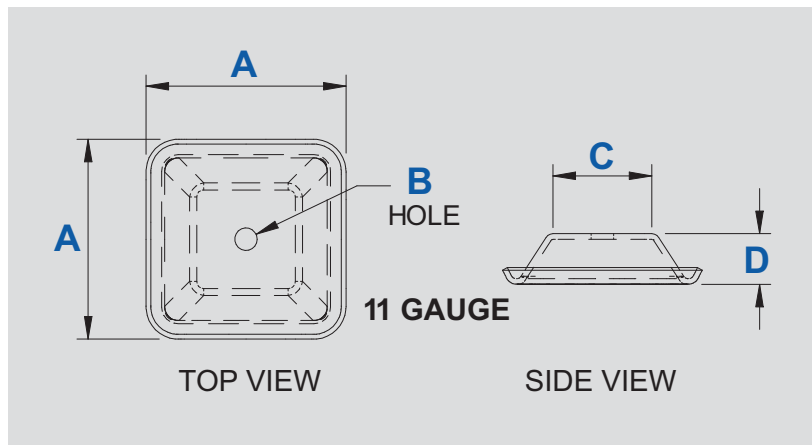

**STEEL**  
Stacking Caps,  
Feet & Receivers



MODEL#	A	B	C	D
C2H-11	4.25"	Ø .5"	2.188"	1.125"
C25H-11	5.25"	Ø .5"	2.688"	1.625"
CL2H-11	4.435"	Ø .5"	2.188"	1.125"
CL25H-11	5.695"	Ø .5"	2.688"	1.625"



All Dimensions are in inches



T217-11

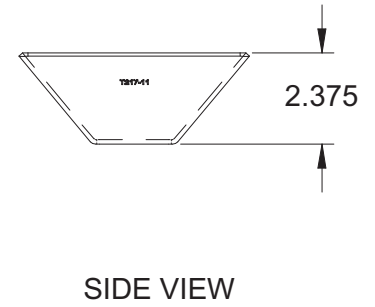
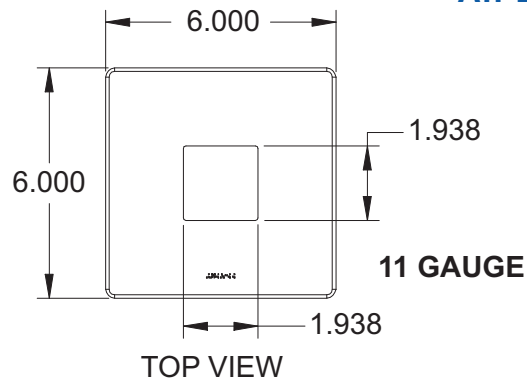

CT4H-8

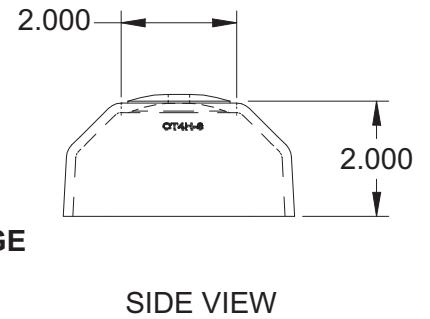
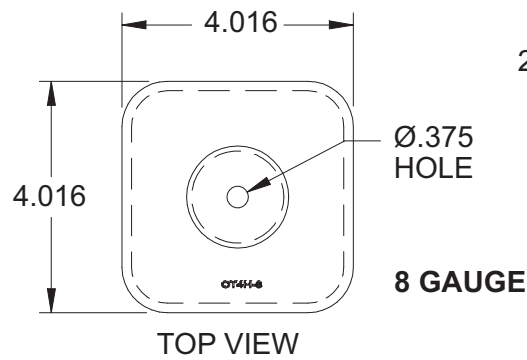

PT2-11

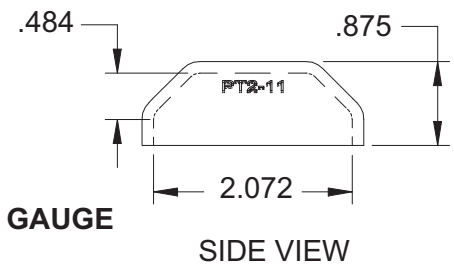
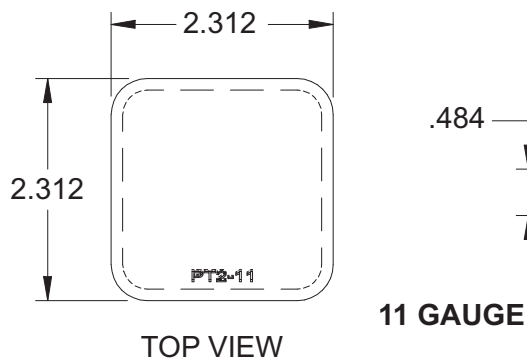

P3L-11

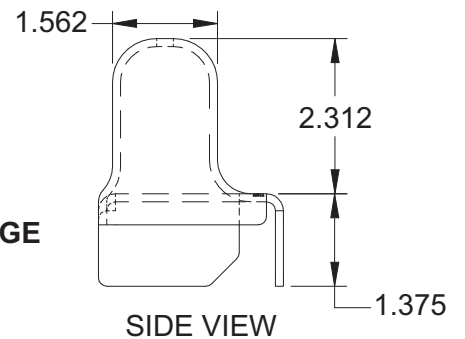
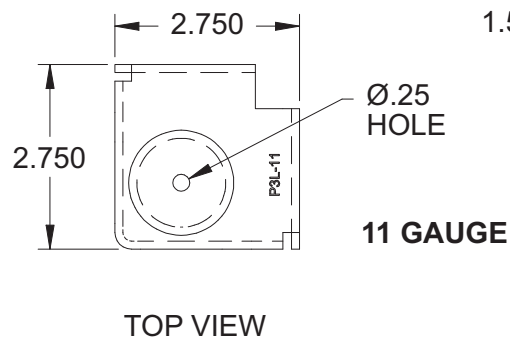

# Steel Stacking Caps, Feet and Receivers



**P15-11**



**P15H-11**



**P2-11**



**P2H-11**



**P25-11**



**P25H-11**

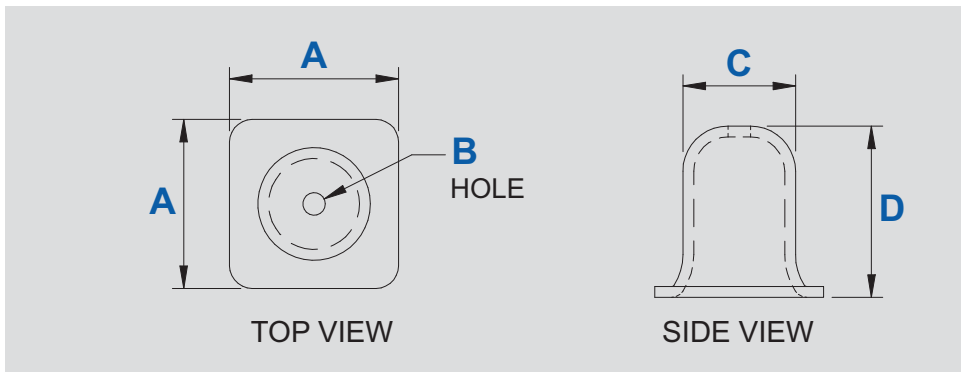

**P3-10**



**P3H-10**

MODEL#	A	B	C	D	GAUGE
P15-11	1.45"	NO HOLE	1.04"	1.496"	11
P15H-11	1.45"	Ø .25"	1.04"	1.496"	11
P2-11	1.875"	NO HOLE	1.25"	1.9"	11
P2H-11	1.875"	Ø .25"	1.25"	1.9"	11
P25-11	2.375"	NO HOLE	1.5"	1.9"	11
P25H-11	2.375"	Ø .25"	1.5"	1.9"	11
P3-10	2.875"	NO HOLE	1.75"	2.205"	10
P3H-10	2.875"	Ø .25"	1.75"	2.205"	10

# Steel Stacking Caps, Feet and Receivers



**P2H-D18**



**P2-D17**



**P25-D39**



**P25H-D28**

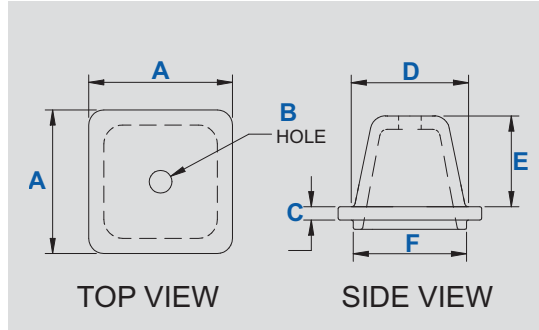

**P3-D37**

MODEL#	A	B	C	D	E	F
P2H-D18	1.875"	Ø .312"	.219"	1.562"	1.5"	1.5"
P25H-D28	2.375"	Ø .375"	.219"	1.938"	1.5"	1.875"
P2-D17	1.988"	NO HOLE	.236"	1.516"	1.732"	1.457"
P25-D39	2.375"	NO HOLE	.219"	1.875"	1.938"	1.875"
P3-D37	2.875"	NO HOLE	.219"	2.062"	1.938"	2.375"

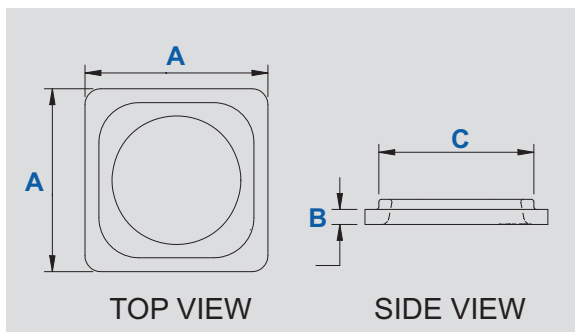
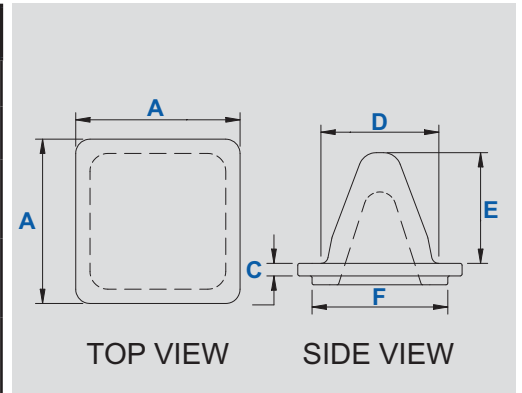

MODEL#	A	B	C
R-D17	1.988"	.236"	1.6"
R-D39	2.438"	.236"	1.938"
R-D37	2.875"	.236"	2.438"



**R-D39**

This receiver is designed for P25-D39



**R-D17**

This receiver is designed for P2-D17



**R-D37**

This receiver is designed for P3-D37